

Multi-position measuring device Semi-automatic

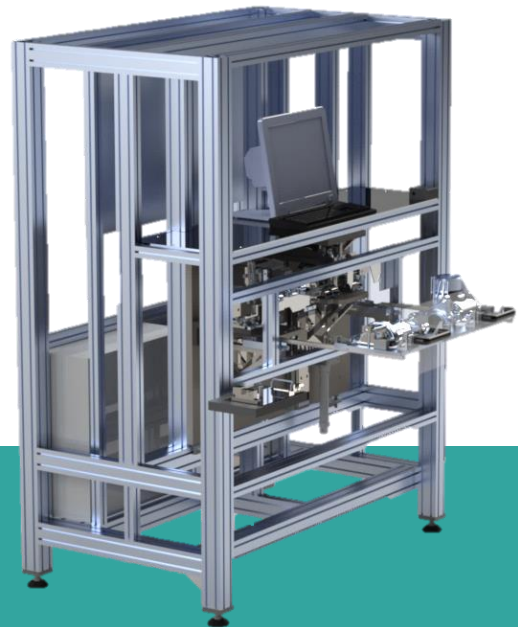

- Measuring device for determining shape, position and dimensional tolerances on bearing boreholes and joint faces of cast two-piece transmission housings

- Measuring principle:
 - Scan of the bearing boreholes and joint faces at several measuring points with analogue measuring sensors
 - Scan of small bearing boreholes (several diameters at the same time) with pneumatic plug gauge
 - Calculation of diameter, axis offset and concentricity of the bearing boreholes
 - Calculation of flatness and symmetry of the joint faces and perpendicularity to the bearing boreholes
 - Check for presence and continuity of individual boreholes with additional sensor technology
 - Spot check for pairing ability and depth of threaded holes with hand-held thread gauge

- 100% inspection or spot check

- 1. Test piece insertion
 2. Test piece coding detection
 3. Comparison of the test piece and machine temperatures
 4. Measuring
 5. OK/NOK visualisation with signal beacon and detailed display of the measurement results on the monitor

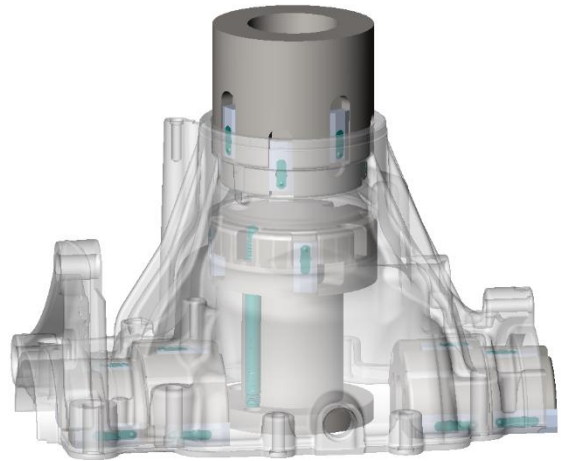
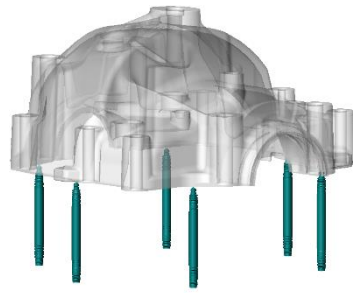

Technical Data

Test piece two-piece cast aluminium transmission housing with bearing boreholes

Measurement data

Diameter 0...110 ±0.002 mm
 Distances 0...100 ±0.005 mm
 Axis distance 0...25 ±0.01 mm
 Concentricity ±0.005 mm

Measuring time incl. handling < 1 min

Measurement data processing

Hardware IPC
 Operating system Windows
 Measuring data software IBR ComGage®
 Visualisation Screen
 Storage csv file
 Export individual QA systems

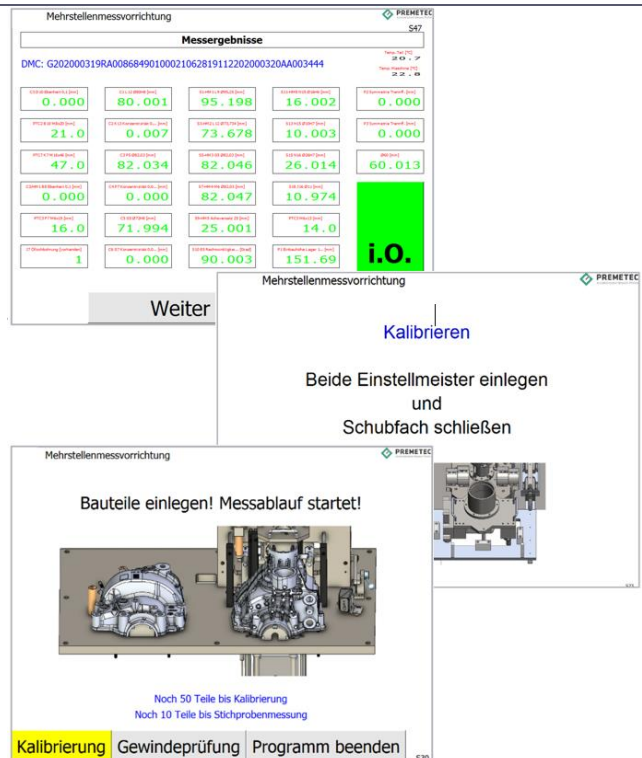

Mehrstellenmessvorrichtung

Messergebnisse

DMC: G202000319RA00868490100021062819112202000320AA003444

0.000	80.001	95.198	16.002	0.000
21.0	0.007	73.678	10.003	0.000
47.0	82.034	82.046	26.014	60.013
0.000	0.000	82.047	10.974	
16.0	71.994	25.001	14.0	
1	0.000	90.003	151.69	i.o.

Weiter

Kalibrieren

Beide Einstellmeister einlegen
und
Schubfach schließen

Bauteile einlegen! Messablauf startet!

Noch 50 Teile bis Kalibrierung
Noch 10 Teile bis Stichprobenmessung

Kalibrierung Gewindeprüfung Programm beenden

Electrical characteristic data IEC
 Supply 230 V / 50 Hz / 16 A
 Control voltage 24 V DC
 Connected load 0.4 kVA
Compressed air connection 6 bar